

EMERGENCIES

As LPG is odourless Calor Gas and Blugas add a special additive to give the gas a distinctive smell and so help the detection of leaks.

NEVER LOOK FOR A LEAK WITH A NAKED FLAME!

In the event of **GAS LEAKAGE** or **SUSPECTED LEAKAGE:**

- Extinguish all naked flames and ignition sources.
- Turn off all gas appliances.
- Do not switch on or off any electrical equipment.
- Open doors and windows to increase ventilation.
- Turn off gas supply at cylinder.
- **NOTIFY** Calor Gas.
- Do not use any gas appliance until it has been made safe.

In the event of **FIRE:**

- Immediately raise the alarm.
- **DO NOT** go near any cylinder in the vicinity of the fire.
- Call the Fire Brigade immediately and inform them that LPG cylinder(s) are on the premises.
- Turn off the gas supply if practicable to do so.

Using **butane** cylinders safely

This leaflet is for the safe use of Calor Gas and Blugas butane cylinders (1kg, 4.5kg, 5kg and 11.34 kg) with a "click-on" valve. If you have any queries please contact your local dealer.

Calor Gas and Blugas supply Liquefied Petroleum Gas (LPG) which is obtained during the process of refining crude oil or direct from Oil Wells. There are two types of LPG – Butane and Propane. Many appliances are designed to be used with either, but it is **important to use the correct pressure reducing device (regulator) as the operating pressure for the two types of gas are different.**

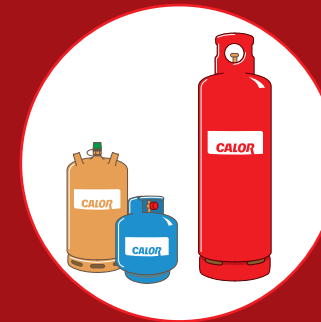

For identification **BUTANE** is supplied in **YELLOW** or **BLUE** cylinders, and **PROPANE** in **RED, GREEN** or **GREY** (Patio Gas) cylinders.

The cylinders are specially made to store the fuel in its liquid state under moderate pressure. The liquid turns to gas vapour, which fills the space above the liquid. As gas is drawn off in use more liquid turns to gas to replace it. A regulator fitted in the supply line to the appliance(s) keeps the gas pressure constant as the cylinder empties – until there is no liquid left to turn to gas

- ✓ **DO** check that the Calor seal is unbroken before purchasing
- ✓ **DO** treat a cylinder with care to ensure the valve is not damaged. A damaged valve could result in a leak with serious consequences.
- ✓ **DO** use a cylinder upright. When horizontal, liquid gas could get into the supply pipes with serious results.
- ✗ **DON'T** store cylinders where they would obstruct means of access, passageways, stairwells, or emergency exits.
- ✗ **DON'T** attempt to disconnect a regulator if the flame does not go out when the regulator switch is turned off. Leave the appliance alight and call your Gas retailer.
- ✗ **DON'T** subject a cylinder to heat because pressure inside the cylinder could build up to a point beyond the designed safety limit.
- ✗ **DON'T** store or use cylinders in cellars, below ground level or near drains or gullies, because butane and propane are heavier than air. If there is a leak the gas could collect at a low level and become dangerous in the presence of a flame or a spark.
- ✗ **DON'T** use propane cylinders indoors residentially, because propane is contained under higher pressure and should only be kept outside. Butane can be used indoors in cabinet heaters, and when installed to the required standard by qualified gas fitters (CORGI registered in Northern Ireland).
- ✗ **DON'T** use cylinders in high rise flats.



Emergency Telephone Numbers:

NORTHERN IRELAND:

Business hours: 028 9045 8466
Outside business hours: 028 9044 2422

Calor Gas

Airport Road West
Belfast BT3 9EE

REPUBLIC OF IRELAND:

Business hours: 01 450 5000
Outside business hours: 01 269 4800

Calor Gas

Long Mile Road
Dublin 12



THE REGULATOR

A regulator will be included in the connection between the cylinder(s) and the appliance(s). Different butane cylinders may have different valves and it is essential that the regulator cylinder connection is compatible with the cylinder valve.

The regulator is precisely set to control the pressure of the supply and **must not be adjusted.**

Some industrial appliances operate at high pressure and are designed to operate at varying pressures depending on the heat output required. For these a special high pressure regulator must be used which incorporates a means of manual adjustment.

If the regulator shows signs of wear it should be replaced.

FLEXIBLE HOSES

- All flexible hoses should have manufacturer's connections or be secured with proper hose clips.
- The hose diameter must be compatible with the hose connection nozzles.
- Make sure that the hoses are kept clear of "hot spots".
- All flexible hoses should be replaced after 5 years of service or if showing signs of wear or damage. **Inspect them frequently.**
- Make sure that where hose end sealing washers are used they are in good condition.
- Hose length should be as short as practicable and shall not extend from one room to another, nor pass through any walls, partitions, ceilings or floors.

- Use only hose approved for use with LPG. For cabinet heaters, patio heaters and barbecues the hose should be to BS3212/2. This standard of hose is also used for high pressure connections including connecting propane cylinders to wall mounted regulators. BS3212/1 hose can be used for low pressure connections to portable appliances. Quick connection hoses to BS669 Part 1 (warranted for use with LPG by the manufacturer) are used for domestic cooker connections.



APPLIANCES

Please read the instructions and labels provided with your appliance and keep them handy for future reference.

Ensure your appliance is designed to burn butane and not, for example, natural gas. The appliance must comply with appropriate European, British and Irish Standards. New appliances must have CE approval.

Appliances must be installed according to the manufacturer's instructions. Only qualified competent people should work on appliances or gas installations.

All burning processes require oxygen, so there must be an adequate supply of fresh air for your appliance. Ventilators or grilles should never be blocked. Please observe the manufacturer's requirements for ventilation.

All gas appliances must be correctly maintained and regularly serviced to the manufacturer's instructions by a competent person (CORGI registered in N.I.).

Cabinet heaters or any other flueless appliance shall not be used in bedrooms, garages or hairdressing salons.

Where practicable, change cylinders out of doors. Cylinders should be changed in a well ventilated area. When changing cylinders indoors opening a window will increase ventilation. No sources of ignition e.g. naked flames, pilot lights, cigarettes, electrical appliances etc. should be nearby.

The cylinder valve, mating connections and sealing washers must be clean and undamaged before making the connection.

After connecting a cylinder a check should always be made that there are no leaks of gas from the cylinder connection. Leaks may also be detected by sound or smell. Leaks may be detected by brushing connections and joints with a leak detection fluid. Bubbles will immediately form at the leak.

BUTANE CYLINDER

Single cylinder installation 4.5kg size (handwheel valve)

This cylinder takes a regulator or flow controller which screws on to the valve outlet. Both have a connecting nut which incorporates a black sealing washer.

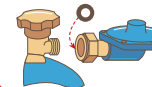

CONNECTING A CYLINDER

- 1 Ensure all gas taps are turned OFF
- 2 Check that the valve handwheel is OFF by turning clockwise
- 3 Remove protective cap and keep to replace later.
- 4 Inspect the black sealing washer for damage before connecting. Replace the washer if faulty
- 5 Fit the connecting nut (left hand thread) to the cylinder using a Calor Gas spanner. Tighten firmly, but do not overtighten as this can damage the washer
- 6 When gas is required, turn the valve handwheel anticlockwise.

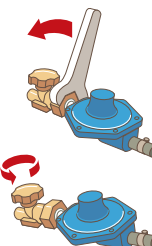

DISCONNECTING A CYLINDER

- 1 Ensure all gas taps are turned OFF.
- 2 Turn the valve handwheel OFF (clockwise rotation)
- 3 NEVER DISCONNECT THE REGULATOR (OR CONNECTING NUT) WITH THE CYLINDER VALVE OPEN
- 4 DISCONNECT the regulator (left hand thread) with a Calor Gas spanner.
- 5 Screw protective cap back on to cylinder valve outlet.

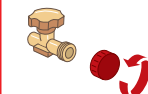
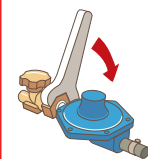

BUTANE CYLINDER

1.5kg, 5kg and 11.34kg ('CLICK-ON' valve)

CONNECTING THE REGULATOR

- 1 Remove the plastic cap from the cylinder valve by turning it anti-clockwise and lifting it up.
- 2 Check the black sealing ring is not cracked or damaged.
- 3 Check regulator lever is OFF position (Red flame Symbol downward) and all appliance gas taps are turned off.
- 4 Hold the regulator in both hands, press the base up into the regulator with the finger tips and place the regulator firmly over cylinder valve.
- 5 Press the base of the regulator downward until a click is heard. The regulator is now in position ensuring a gas-tight connection.
- 6 Turn the lever on top of the regulator over to the ON position, indicated by red flame symbol facing upwards. Gas supply is now ready for use.

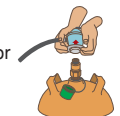
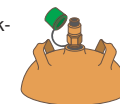

DISCONNECTING THE REGULATOR

- 1 Ensure all gas taps are turned OFF.
- 2 Turn the lever to the OFF position (red flame symbol downwards).
- 3 Clasp the regulator in both hands and press the black base up into the regulator which can then be removed from the cylinder valve.
- 4 Replace the plastic cap by turning it clockwise. This will protect the cylinder valve.

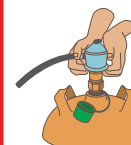

If in Doubt, Contact your Gas Retailer